

21

The students in a class want to build the type of seesaw shown below. The students can make the seesaw out of any material, but they know some materials have properties that make them a better choice to use for the seesaw than other materials.

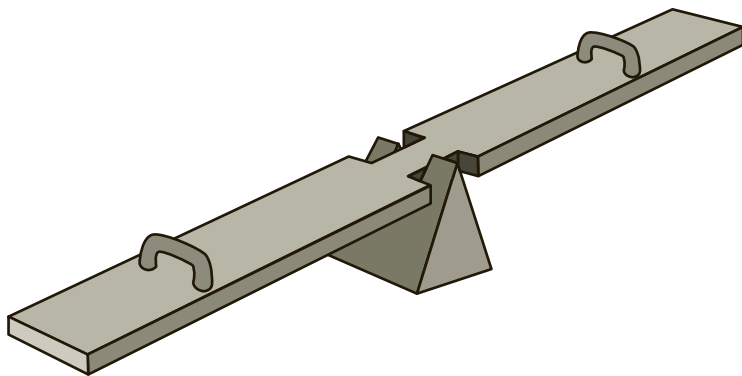

- Identify **one** material that would be a good choice for the students to use to build the seesaw.
- Describe **two** properties of the material you identified in part (a) that make it a good choice to use to build the seesaw.
- Describe **one** design feature that the students should consider before building the seesaw. Explain your answer.